

## Addendum No. 3

---

Date: October 11, 2023

---

**Project: Flint Hills Area Transportation Agency (ATA)**

---

Project No.: 21-023

---

**Flint Hills Area Transportation Agency (ATA)**  
**5815 Marlatt Ave**  
**Manhattan, KS 66503**

The following addendum items amend the Drawings, Specifications, and other Project Manual documents prepared by Anderson Knight Architects, 2505 Anderson Avenue, Suite 201, Manhattan, Kansas 66502.

### **CLARIFICATIONS:**

1. See attached Specification Sections inadvertently left out of the full specifications.
2. See attached sheet ASP1.01 inadvertently left out of the set.

# ATA Remodel

5815 MARLATT AVE  
MANHATTAN, KS 66503

PROJECT NO. 21023

DATE 09.01.2023

ISSUE RECORD

FOR BID

REVISION # 1

ASP1.01

Architectural Site Plan

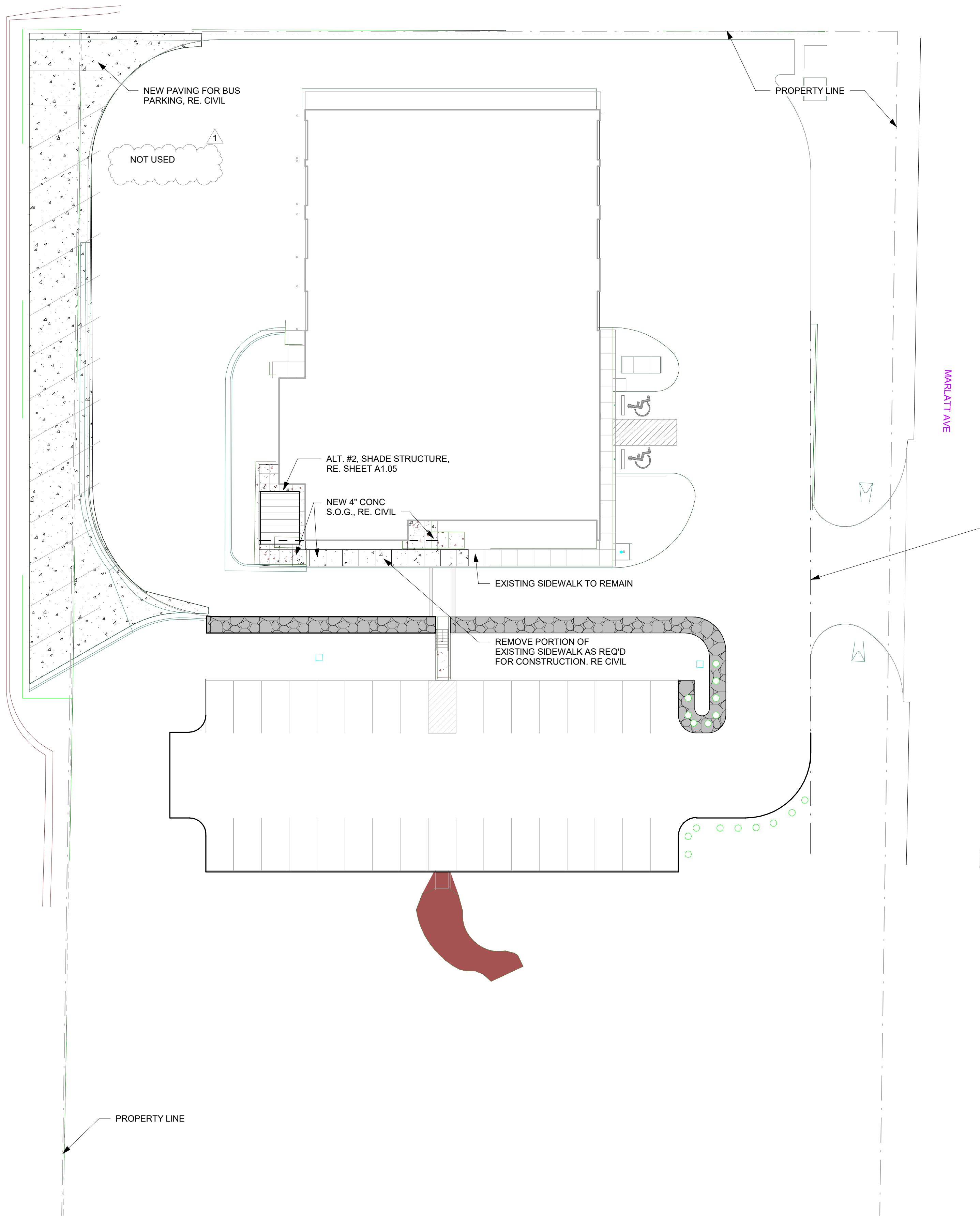

EXISTING GATE. REMOVE AND RE-INSTALL AS REQUIRED SO GATES ARE LEVEL. EXTEND EXISTING OR PROVIDE NEW TALLER POST(S), AS REQUIRED MATCH EXISTING POST. PROVIDE CHAIN LINK FENCING BETWEEN DRIVE AND BOTTOM OF RAISED GATE. INTENT IS FOR TOP OF GATES TO LINE UP AND OPERATE SMOOTHLY AND EASILY WHILE PROVIDING INFILL BELOW GATE TO FILL THE GAP CREATED DURING LEVELING. PROVIDE LIFTMASTER MODEL CSL24UL OR APPROVED GATE OPERATOR AT EACH GATE.

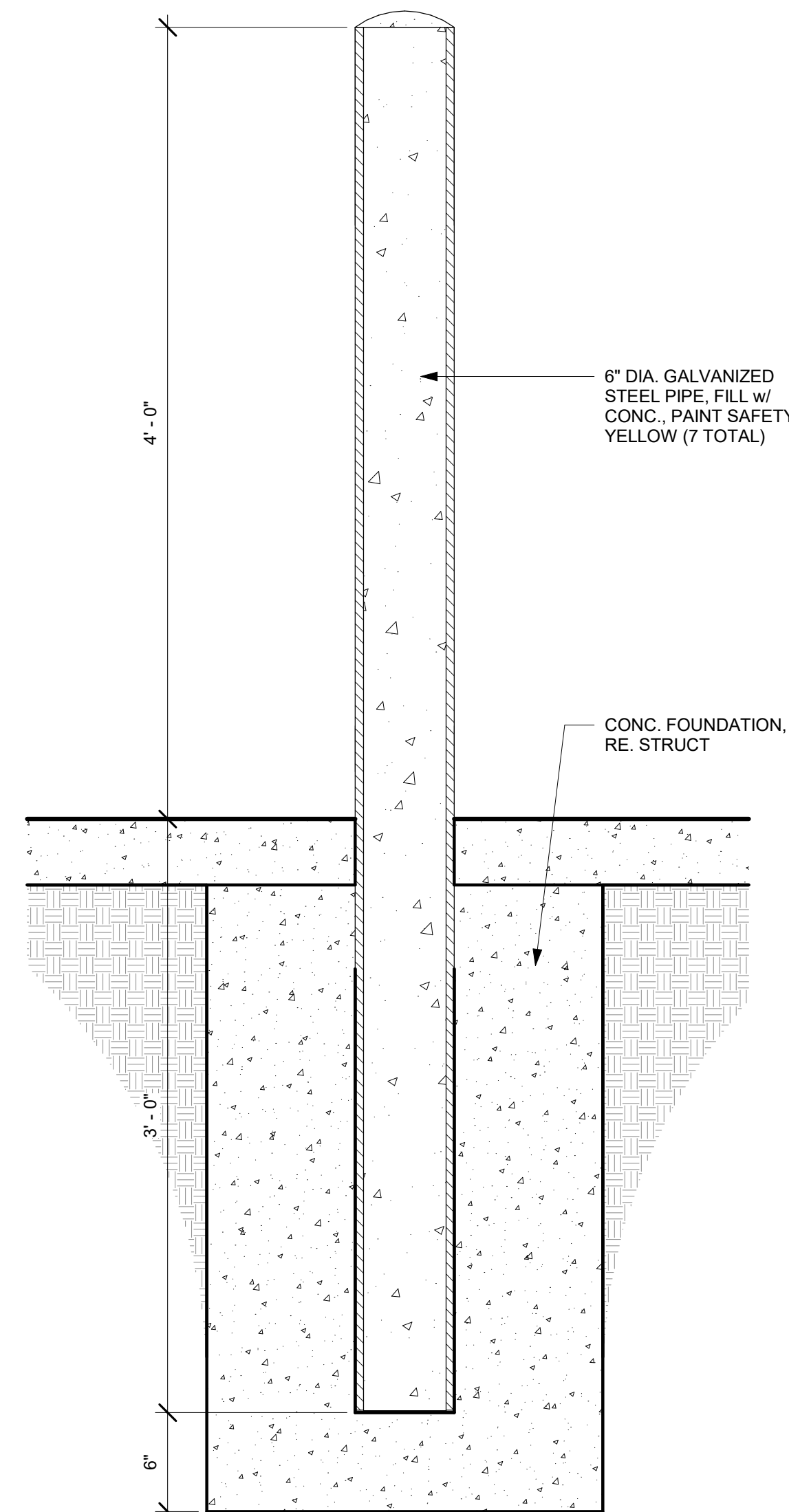

PLAN NORTH



1 Architectural Site Plan  
ASP1.01 1" = 20'-0"

2 Existing Gate (For Reference Only)  
ASP1.01 1" = 1'-0"

3 Detail @ Bollard @ Alt. #1  
ASP1.01 1 1/2" = 1'-0"

SECTION 064116  
PLASTIC-LAMINATE-CLAD  
ARCHITECTURAL

SECTION 064116 - PLASTIC-LAMINATE-CLAD ARCHITECTURAL CABINETS

PART 1 - GENERAL

1.1 SUMMARY

A. Section Includes:

1. Plastic-laminate-clad architectural wall panel, as shown in plans.

1.2 COORDINATION

- A. Coordinate sizes and locations of framing, blocking, furring, reinforcements, and other related units of Work specified in other Sections to support loads imposed by installed and fully loaded cabinets.

1.3 ACTION SUBMITTALS

A. Product Data Submittals: For each product.

1. Include data for fire-retardant treatment from chemical-treatment manufacturer and certification by treating plant that treated materials comply with requirements.

- B. Samples: For each exposed product and for each color and texture specified, in manufacturer's or manufacturer's standard size.

C. Samples for Verification: For the following:

1. Plastic Laminates: 8 by 10 inches, for each type, color, pattern, and surface finish required.
  - a. Provide one sample applied to core material with specified edge material applied to one edge.

1.4 INFORMATIONAL SUBMITTALS

A. Qualification Data: For manufacturer.

B. Product Certificates: For the following:

1. High-pressure decorative laminate.
2. Adhesives.

1.5 CLOSEOUT SUBMITTALS

1.6 QUALITY ASSURANCE

- A. Manufacturer's Qualifications: Employs skilled workers who custom fabricate products similar to those required for this Project and whose products have a record of successful in-service performance.



SECTION 064116  
PLASTIC-LAMINATE-CLAD  
ARCHITECTURAL

1.7 DELIVERY, STORAGE, AND HANDLING

- A. Do not deliver panel until painting and similar finish operations that might damage architectural panel have been completed in installation areas. Store panel in installation area or in areas where environmental conditions comply with requirements specified in "Field Conditions" Article.

1.8 FIELD CONDITIONS

- A. Environmental Limitations with Humidity Control: Do not deliver or install cabinets until building is enclosed, wet-work is complete, and HVAC system is operating and maintaining temperature between 60 and 90 deg F and relative humidity between 25 and 55 percent during the remainder of the construction period.
- B. Field Measurements: Where panel is indicated to fit to other construction, verify dimensions of other construction by field measurements before fabrication, and indicate measurements on Shop Drawings. Coordinate fabrication schedule with construction progress to avoid delaying the Work.
  - 1. Locate concealed framing, blocking, and reinforcements that support cabinets by field measurements before being enclosed/concealed by construction, and indicate measurements on Shop Drawings.

PART 2 - PRODUCTS

2.1 PLASTIC-LAMINATE-CLAD ARCHITECTURAL CABINETS

- A. High-Pressure Decorative Laminate: ISO 4586-3, grades as indicated or if not indicated, as required by quality standard.
  - 1. Manufacturers: Subject to compliance with requirements, provide products by the following:
    - a. Wilsonart LLC, Color: White Tigris, 4783-60

2.2 MISCELLANEOUS MATERIALS

- A. Furring, Blocking, Shims, and Hanging Strips: Fire-retardant-treated softwood lumber, kiln-dried to less than 15 percent moisture content.
- B. Adhesives: Do not use adhesives that contain urea formaldehyde.

PART 3 - EXECUTION

3.1 PREPARATION

- A. Before installation, condition panel to humidity conditions in installation areas for not less than 72 hours.

SECTION 064116  
PLASTIC-LAMINATE-CLAD  
ARCHITECTURAL

END OF SECTION 064116

SECTION 096513  
RESILIENT BASE AND ACCESSORIES

SECTION 096513 - RESILIENT BASE AND ACCESSORIES

PART 1 - GENERAL

1.1 SUMMARY

- A. Section Includes:
  - 1. Thermoset-rubber base.
  - 2. Thermoplastic-rubber base.
  - 3. Rubber molding accessories.

1.2 ACTION SUBMITTALS

- A. Product Data: For each type of product.
- B. Samples for Verification: For each type of product indicated and for each color, texture, and pattern required in manufacturer's standard-size Samples, but not less than 6 inches long.

1.3 MAINTENANCE MATERIAL SUBMITTALS

- A. Furnish extra materials, from the same product run, that match products installed and that are packaged with protective covering for storage and identified with labels describing contents.
  - 1. Furnish not less than 10 linear feet for every 500 linear feet or fraction thereof, of each type, color, pattern, and size of resilient product installed.

1.4 DELIVERY, STORAGE, AND HANDLING

- A. Store resilient products and installation materials in dry spaces protected from the weather, with ambient temperatures maintained within range recommended by manufacturer, but not less than 55 deg F or more than 90 deg F.

1.5 FIELD CONDITIONS

- A. Maintain ambient temperatures within range recommended by manufacturer, but not less than , in spaces to receive resilient products during the following periods:70 deg F or more than , in spaces to receive resilient products during the following periods:95 deg F, in spaces to receive resilient products during the following periods:
  - 1. 48 hours before installation.
  - 2. During installation.
  - 3. 48 hours after installation.
- B. After installation and until Substantial Completion, maintain ambient temperatures within range recommended by manufacturer, but not less than 55 deg F or more than 95 deg F.

SECTION 096513  
RESILIENT BASE AND ACCESSORIES

- C. Install resilient products after other finishing operations, including painting, have been completed.

PART 2 - PRODUCTS

2.1 THERMOSET-RUBBER BASE

- A. Manufacturers: Subject to compliance with requirements, provide products by one of the following:
  - 1. Flexco Corporation
  - 2. Johnsonite; a Tarkett company
  - 3. Roppe Corporation; Roppe Holding Company
- B. Product Standard: ASTM F1861, Type TS (rubber, vulcanized thermoset), Group I (solid, homogeneous).
  - 1. Style and Location:
    - a. Style B, Cove: All areas.
- C. Thickness: 0.125 inch.
- D. Height: 4 inches.
- E. Lengths: Coils in manufacturer's standard length.
- F. Outside Corners: Job formed.
- G. Inside Corners: Job formed.
- H. Colors: Match existing.

2.2 THERMOPLASTIC-RUBBER BASE

- A. Manufacturers: Subject to compliance with requirements, :
  - 1. Flexco Corporation
  - 2. Johnsonite; a Tarkett company
  - 3. Roppe Corporation; Roppe Holding Company
  - 4. VPI Corporation
- B. Product Standard: ASTM F1861, Type TP (rubber, thermoplastic).
  - 1. Group: I (solid, homogeneous).
  - 2. Style and Location:
    - a. Style B, Cove: in all areas.
- C. Thickness: 0.125 inch.

SECTION 096513  
RESILIENT BASE AND ACCESSORIES

- D. Height: 4 inches.
- E. Lengths: Coils in manufacturer's standard length.
- F. Outside Corners: Job formed.
- G. Inside Corners: Job formed.
- H. Colors: match existing.

2.3 RUBBER MOLDING ACCESSORY

- A. Manufacturers: Subject to compliance with requirements, provide products by one of the following:
  - 1. Roppe Corporation; Roppe Holding Company
  - 2. VPI Corporation
- B. Description: Rubber carpet edge for glue-down applications, nosing for carpet, transition strips.
- C. Profile and Dimensions: Match existing.
- D. Colors and Patterns: Match existing.

2.4 INSTALLATION MATERIALS

- A. Trowelable Leveling and Patching Compounds: Latex-modified, portland-cement-based or blended hydraulic-cement-based formulation provided or approved by resilient-product manufacturer for applications indicated.
- B. Adhesives: Water-resistant type recommended by resilient-product manufacturer for resilient products and substrate conditions indicated.

PART 3 - EXECUTION

3.1 EXAMINATION

- A. Examine substrates, with Installer present, for compliance with requirements for maximum moisture content and other conditions affecting performance of the Work.
  - 1. Verify that finishes of substrates comply with tolerances and other requirements specified in other Sections and that substrates are free of cracks, ridges, depressions, scale, and foreign deposits that might interfere with adhesion of resilient products.
- B. Proceed with installation only after unsatisfactory conditions have been corrected.
  - 1. Installation of resilient products indicates acceptance of surfaces and conditions.



SECTION 096513  
RESILIENT BASE AND ACCESSORIES

3.2 PREPARATION

- A. Prepare substrates according to manufacturer's written instructions to ensure adhesion of resilient products.
- B. Concrete Substrates for Resilient Stair Accessories: Prepare horizontal surfaces according to ASTM F710.
  - 1. Verify that substrates are dry and free of curing compounds, sealers, and hardeners.
  - 2. Remove substrate coatings and other substances that are incompatible with adhesives and that contain soap, wax, oil, or silicone, using mechanical methods recommended by manufacturer. Do not use solvents.
  - 3. Alkalinity and Adhesion Testing: Perform tests recommended by manufacturer. Proceed with installation only after substrate alkalinity falls within range on pH scale recommended by manufacturer in writing, but not less than 5 or more than 10 pH.
  - 4. Moisture Testing: Perform tests so that each test area does not exceed 1000 sq. ft., and perform no fewer than three tests in each installation area and with test areas evenly spaced in installation areas.
- C. Fill cracks, holes, and depressions in substrates with trowelable leveling and patching compound; remove bumps and ridges to produce a uniform and smooth substrate.
- D. Do not install resilient products until materials are the same temperature as space where they are to be installed.
  - 1. At least 48 hours in advance of installation, move resilient products and installation materials into spaces where they will be installed.
- E. Immediately before installation, sweep and vacuum clean substrates to be covered by resilient products.

3.3 RESILIENT BASE INSTALLATION

- A. Comply with manufacturer's written instructions for installing resilient base.
- B. Apply resilient base to walls, columns, pilasters, casework and cabinets in toe spaces, and other permanent fixtures in rooms and areas where base is required.
- C. Install resilient base in lengths as long as practical without gaps at seams and with tops of adjacent pieces aligned.
- D. Tightly adhere resilient base to substrate throughout length of each piece, with base in continuous contact with horizontal and vertical substrates.
- E. Do not stretch resilient base during installation.
- F. On masonry surfaces or other similar irregular substrates, fill voids along top edge of resilient base with manufacturer's recommended adhesive filler material.

SECTION 096513  
RESILIENT BASE AND ACCESSORIES

G. Job-Formed Corners:

1. Outside Corners: Use straight pieces of maximum lengths possible and form with returns not less than 3 inches in length.
  - a. Form without producing discoloration (whitening) at bends.
2. Inside Corners: Use straight pieces of maximum lengths possible and form with returns not less than 3 inches in length.
  - a. Miter or cope corners to minimize open joints.

3.4 RESILIENT ACCESSORY INSTALLATION

- A. Comply with manufacturer's written instructions for installing resilient accessories.
- B. Resilient Molding Accessories: Butt to adjacent materials and tightly adhere to substrates throughout length of each piece. Install reducer strips at edges of floor covering that would otherwise be exposed.

3.5 CLEANING AND PROTECTION

- A. Comply with manufacturer's written instructions for cleaning and protecting resilient products.
- B. Perform the following operations immediately after completing resilient-product installation:
  1. Remove adhesive and other blemishes from surfaces.
  2. Sweep and vacuum horizontal surfaces thoroughly.
  3. Damp-mop horizontal surfaces to remove marks and soil.
- C. Protect resilient products from mars, marks, indentations, and other damage from construction operations and placement of equipment and fixtures during remainder of construction period.
- D. Cover resilient products subject to wear and foot traffic until Substantial Completion.

END OF SECTION 096513

096813 - 1  
TILE CARPETING

SECTION 096813 - TILE CARPETING

PART 1 - GENERAL

1.1 SUMMARY

A. Section Includes:

1. Modular carpet tile.

B. Related Requirements:

1. Section 024119 "Selective Demolition" for removing existing floor coverings.
2. Section 096513 "Resilient Base and Accessories" for resilient wall base and accessories installed with carpet tile.

1.2 PREINSTALLATION MEETINGS

A. Preinstallation Conference: Conduct conference at Project site.

1. Review methods and procedures related to carpet tile installation including, but not limited to, the following:
  - a. Review ambient conditions and ventilation procedures.
  - b. Review subfloor preparation procedures.

1.3 ACTION SUBMITTALS

A. Product Data: For each type of product.

1. Include manufacturer's written data on physical characteristics, durability, and fade resistance.
2. Include manufacturer's written installation recommendations for each type of substrate.

B. Shop Drawings: For carpet tile installation, plans showing the following:

1. Carpet tile type, color, and dye lot.
2. Type of installation.
3. Pattern of installation, Ashlar method.
4. Transition details to other flooring materials, to match existing.

C. Samples: For each of the following products and for each color and texture required. Label each Sample with manufacturer's name, material description, color, pattern, and designation indicated on Drawings and in schedules.

1. Carpet Tile: Full-size Sample.
2. Exposed Edge, Transition, and Other Accessory Stripping: 6-inch- long Samples, match existing.

D. Product Schedule: For carpet tile. Use same designations indicated on Drawings.

#### 1.4 INFORMATIONAL SUBMITTALS

- A. Qualification Data: For Installer.
- B. Product Test Reports: For carpet tile, for tests performed by a qualified testing agency.
- C. Sample Warranty: For special warranty.

#### 1.5 CLOSEOUT SUBMITTALS

- A. Maintenance Data: For carpet tiles to include in maintenance manuals. Include the following:
  - 1. Methods for maintaining carpet tile, including cleaning and stain-removal products and procedures and manufacturer's recommended maintenance schedule.
  - 2. Precautions for cleaning materials and methods that could be detrimental to carpet tile.

#### 1.6 MAINTENANCE MATERIAL SUBMITTALS

- A. Furnish extra materials, from the same product run, that match products installed and that are packaged with protective covering for storage and identified with labels describing contents.
  - 1. Carpet Tile: Full-size units equal to 5 percent of amount installed for each type indicated, but not less than 10 sq. yd.

#### 1.7 QUALITY ASSURANCE

- A. Installer Qualifications: An experienced installer who is certified by the International Certified Floorcovering Installers Association at the Commercial II, Master II certification level.

#### 1.8 DELIVERY, STORAGE, AND HANDLING

- A. Comply with the Carpet and Rug Institute's CRI 104.

#### 1.9 FIELD CONDITIONS

- A. Comply with the Carpet and Rug Institute's CRI 104 for temperature, humidity, and ventilation limitations.
- B. Environmental Limitations: Do not deliver or install carpet tiles until spaces are enclosed and weathertight, wet-work in spaces is complete and dry, and ambient temperature and humidity conditions are maintained at levels planned for building occupants during the remainder of the construction period.
- C. Do not install carpet tiles over concrete slabs until slabs have cured and are sufficiently dry to bond with adhesive and concrete slabs have pH range recommended by carpet

tile manufacturer.

#### 1.10 WARRANTY

- A. Special Warranty for Carpet Tiles: Manufacturer agrees to repair or replace components of carpet tile installation that fail in materials or workmanship within specified warranty period.
  - 1. Warranty does not include deterioration or failure of carpet tile due to unusual traffic, failure of substrate, vandalism, or abuse.
  - 2. Failures include, but are not limited to, the following:
    - a. More than 10 percent edge raveling, snags, and runs.
    - b. Dimensional instability.
    - c. Excess static discharge.
    - d. Loss of tuft-bind strength.
    - e. Loss of face fiber.
    - f. Delamination.
    - g. Moisture Barrier.
  - 3. Warranty Period: Lifetime years from date of Substantial Completion.

### PART 2 - PRODUCTS

#### 2.1 CARPET TILE

- A. Manufacturers: Subject to compliance with requirements, provide products by the following:
  - 1. J&J Flooring Group LLC
- B. Pattern: Style City Blocks III (Style 7202) modular.
- C. Color: As indicated by manufacturer's designations, 3341 Grand Square.
- D. Fiber Type: Encore SD Nylon & Encore Nylon with ColorLoc Plus.
- E. Pile Characteristic: Textured Patterned Loop pile.
- F. Density: 6542 oz / y3.
- G. Stitches: 9.50 stitches per inch.
- H. Gage: 1/12.
- I. Surface Pile Weight: 18 oz./sq. yd..
- J. Primary Backing/Backcoating: Manufacturer's standard composite materials.
- K. Backing System: Nexus Modular Backing.

- L. Size: 24 by 24 inches.
- M. Applied Treatments:
  - 1. Soil-Resistance Treatment: Manufacturer's standard treatment, ProTex Soil Release and Colorloc Plus.
  - 2. Antimicrobial Treatment: Manufacturer's standard treatment that protects carpet tiles as follows:
    - a. Antimicrobial Activity: Not less than 2-mm halo of inhibition for gram-positive bacteria, not less than 1-mm halo of inhibition for gram-negative bacteria, and no fungal growth, according to AATCC 174.
- N. Performance Characteristics:
  - 1. Critical Radiant Flux Classification: Not less than 0.45 W/sq. cm according to Less than 450.0 flaming ASTM E 662.
  - 2. Colorfastness to Crocking: Not less than 4, wet and dry, according to AATCC 165.
  - 3. Electrostatic Propensity: Less than Less than 3.0 kV according to AATCC 134.

## 2.2 INSTALLATION ACCESSORIES

- A. Trowelable Leveling and Patching Compounds: Latex-modified, hydraulic-cement-based formulation provided or recommended by carpet tile manufacturer.
- B. Adhesives: Water-resistant, mildew-resistant, nonstaining, pressure-sensitive type to suit products and subfloor conditions indicated, that comply with flammability requirements for installed carpet tile, and are recommended by carpet tile manufacturer for releasable installation.
  - 1. Adhesives shall have a VOC content of 50 g/L or less.

## PART 3 - EXECUTION

### 3.1 EXAMINATION

- A. Examine substrates, areas, and conditions, with Installer present, for compliance with requirements for maximum moisture content, alkalinity range, installation tolerances, and other conditions affecting carpet tile performance.
- B. Examine carpet tile for type, color, pattern, and potential defects.
- C. Concrete Slabs: Verify that finishes comply with requirements specified in Section 033000 "Cast-in-Place Concrete" and that surfaces are free of cracks, ridges, depressions, scale, and foreign deposits.
  - 1. Moisture Testing: Perform tests so that each test area does not exceed 1000 sq. ft., and perform no fewer than three tests in each installation area and with test



areas evenly spaced in installation areas.

- a. Anhydrous Calcium Chloride Test: ASTM F1869. Proceed with installation only after substrates have maximum moisture-vapor-emission rate of 3 lb of water/1000 sq. ft. in 24 hours.
  - b. Relative Humidity Test: Using in situ probes, ASTM F2170. Proceed with installation only after substrates have a maximum 75 percent relative humidity level measurement.
  - c. Perform additional moisture tests recommended in writing by adhesive and carpet tile manufacturers. Proceed with installation only after substrates pass testing.
- D. Proceed with installation only after unsatisfactory conditions have been corrected.

### 3.2 PREPARATION

- A. General: Comply with the Carpet and Rug Institute's CRI 104 and with carpet tile manufacturer's written installation instructions for preparing substrates indicated to receive carpet tile.
- B. Use trowelable leveling and patching compounds, according to manufacturer's written instructions, to fill cracks, holes, depressions, and protrusions in substrates. Fill or level cracks, holes and depressions 1/8" inch wide or wider, and protrusions more than 1/32" inch unless more stringent requirements are required by manufacturer's written instructions.
- C. Concrete Substrates: Remove coatings, including curing compounds, and other substances that are incompatible with adhesives and that contain soap, wax, oil, or silicone, without using solvents. Use mechanical methods recommended in writing by adhesive and carpet tile manufacturers.
- D. Broom and vacuum clean substrates to be covered immediately before installing carpet tile.

### 3.3 INSTALLATION

- A. General: Comply with the Carpet and Rug Institute's CRI 104, Section 10, "Carpet Tile," and with carpet tile manufacturer's written installation instructions.
- B. Installation Method: As recommended in writing by carpet tile manufacturer – Ashlar method.
- C. Maintain dye-lot integrity. Do not mix dye lots in same area.
- D. Maintain pile-direction patterns recommended in writing by carpet tile manufacturer.
- E. Cut and fit carpet tile to butt tightly to vertical surfaces, permanent fixtures, and built-in furniture including cabinets, pipes, outlets, edgings, thresholds, and nosings. Bind or seal cut edges as recommended by carpet tile manufacturer.

096813 - 6  
TILE CARPETING

- F. Extend carpet tile into toe spaces, door reveals, closets, open-bottomed obstructions, removable flanges, alcoves, and similar openings.
- G. Maintain reference markers, holes, and openings that are in place or marked for future cutting by repeating on carpet tile as marked on subfloor. Use nonpermanent, nonstaining marking device.
- H. Install pattern parallel to walls and borders.

3.4 CLEANING AND PROTECTION

- A. Perform the following operations immediately after installing carpet tile:
  - 1. Remove excess adhesive and other surface blemishes using cleaner recommended by carpet tile manufacturer.
  - 2. Remove yarns that protrude from carpet tile surface.
  - 3. Vacuum carpet tile using commercial machine with face-beater element.
- B. Protect installed carpet tile to comply with the Carpet and Rug Institute's CRI 104, Section 13.7.
- C. Protect carpet tile against damage from construction operations and placement of equipment and fixtures during the remainder of construction period. Use protection methods indicated or recommended in writing by carpet tile manufacturer.

END OF SECTION 096813

SECTION 123661.16 - SOLID SURFACING COUNTERTOPS

PART 1 - GENERAL

1.1 SUMMARY

- A. Section Includes:
  - 1. Solid surface material countertops.
  - 2. Solid surface material backsplashes.
  - 3. Solid surface material end splashes.

1.2 ACTION SUBMITTALS

- A. Product Data: For countertop materials.
- B. Shop Drawings: For countertops. Show materials, finishes, edge and backsplash profiles, methods of joining, and cutouts for plumbing fixtures.
  - 1. Show locations and details of joints.
- C. Samples for Verification: For the following products:
  - 1. Countertop material, 6" inches square.

1.3 INFORMATIONAL SUBMITTALS

- A. Qualification Data: For fabricator.

1.4 CLOSEOUT SUBMITTALS

- A. Maintenance Data: For solid surface material countertops to include in maintenance manuals. Include Product Data for care products used or recommended by Installer and names, addresses, and telephone numbers of local sources for products.

1.5 QUALITY ASSURANCE

- A. Fabricator Qualifications: Shop that employs skilled workers who custom-fabricate countertops similar to that required for this Project, and whose products have a record of successful in-service performance.
- B. Installer Qualifications: Fabricator of countertops.

1.6 FIELD CONDITIONS

- A. Field Measurements: Verify dimensions of countertops by field measurements before countertop fabrication is complete. After original plastic laminate countertops are removed.

123661.16  
SOLID SURFACING COUNTERTOPS

1.7 COORDINATION

- A. Coordinate locations of utilities that will penetrate countertops or backsplashes.

PART 2 - PRODUCTS

2.1 SOLID SURFACE COUNTERTOP MATERIALS

- A. Solid Surface Material: Homogeneous-filled plastic resin complying with ISFA 2-01.
  - 1. Manufacturers: Subject to compliance with requirements, provide products by the following:
    - a. Wilsonart LLC: Solid Surface
  - 2. Type: Provide Standard type or Veneer type made from material complying with requirements for Standard type, as indicated unless Special Purpose type is indicated.
  - 3. Colors and Patterns: As indicated by manufacturer's designations.
    - a. Beachfront 9233SS
- B. Particleboard: ANSI A208.1, Grade M-2-Exterior Glue.
- C. Plywood: Exterior softwood plywood complying with DOC PS 1, Grade C-C Plugged, touch sanded.

2.2 FABRICATION

- A. Fabricate countertops according to solid surface material manufacturer's written instructions and to the AWI/AWMAC/WI's "Architectural Woodwork Standards."
  - 1. Grade: Premium.
- B. Configuration:
  - 1. Front: Straight, slightly eased at top.
  - 2. Backsplash: Straight, slightly eased at corner.
  - 3. End Splash: Matching backsplash.
- C. Countertops:
  - 1. 1/2-inch- thick, solid surface material with front edge built up with same material.
- D. Backsplashes: 1/2-inch- thick, solid surface material.
- E. Fabricate tops with shop-applied edges and backsplashes unless otherwise indicated. Comply with solid surface material manufacturer's written instructions for adhesives,

123661.16  
SOLID SURFACING COUNTERTOPS

sealers, fabrication, and finishing.

1. Fabricate with loose backsplashes for field assembly.

F. Joints:

1. Fabricate countertops without joints unless unavoidable.
2. Fabricate countertops in sections for joining in field, with joints at locations indicated.
  - a. Joint Locations: Not within 18 inches of a sink or cooktop and not where a countertop section less than 36 inches long would result, unless unavoidable.
  - b. Splined Joints: Accurately cut kerfs in edges at joints for insertion of metal splines to maintain alignment of surfaces at joints where indicated. Make width of cuts slightly more than thickness of splines to provide snug fit. Provide at least three splines in each joint.

G. Cutouts and Holes:

1. Undercounter Plumbing Fixtures: Make cutouts for fixtures in shop using template or pattern furnished by fixture manufacturer. Form cutouts to smooth, even curves.
  - a. Provide vertical edges, slightly eased at juncture of cutout edges with top and bottom surfaces of countertop and projecting 3/16 inch into fixture opening.
2. Counter-Mounted Plumbing Fixtures: Prepare countertops in shop for field cutting openings for counter-mounted fixtures. Mark tops for cutouts and drill holes at corners of cutout locations. Make corner holes of largest radius practical.
3. Fittings: Drill countertops in shop for plumbing fittings, undercounter soap dispensers, and similar items.
4. Counter-Mounted Cooktops: Prepare countertops in shop for field cutting openings for cooktops. Mark tops for cutouts and drill holes at corners of cutout locations. Make corner holes of largest radius practical.

2.3 INSTALLATION MATERIALS

A. Adhesive: Product recommended by solid surface material manufacturer.

1. Adhesives shall have a VOC content of 70 g/L or less.

B. Sealant for Countertops: Comply with applicable requirements in Section 079200 "Joint Sealants."

123661.16  
SOLID SURFACING COUNTERTOPS

PART 3 - EXECUTION

3.1 EXAMINATION

- A. Examine substrates to receive solid surface material countertops and conditions under which countertops will be installed, with Installer present, for compliance with requirements for installation tolerances and other conditions affecting performance of countertops.
- B. Proceed with installation only after unsatisfactory conditions have been corrected.

3.2 INSTALLATION

- A. Install countertops level to a tolerance of 1/8" maximum. Do not exceed 1/64"-inch difference between planes of adjacent units.
- B. Fasten countertops by screwing through corner blocks of base units into underside of countertop. Predrill holes for screws as recommended by manufacturer. Align adjacent surfaces and, using adhesive in color to match countertop, form seams to comply with manufacturer's written instructions. Carefully dress joints smooth, remove surface scratches, and clean entire surface.
- C. Fasten subtops to cabinets by screwing through subtops into cornerblocks of base cabinets. Shim as needed to align subtops in a level plane.
- D. Secure countertops to subtops with adhesive according to solid surface material manufacturer's written instructions. Align adjacent surfaces and, using adhesive in color to match countertop, form seams to comply with manufacturer's written instructions. Carefully dress joints smooth, remove surface scratches, and clean entire surface.
- E. Bond joints with adhesive and draw tight as countertops are set. Mask areas of countertops adjacent to joints to prevent adhesive smears.
  - 1. Install metal splines in kerfs in countertop edges at joints. Fill kerfs with adhesive before inserting splines and remove excess immediately after adjoining units are drawn into position.
  - 2. Clamp units to temporary bracing, supports, or each other to ensure that countertops are properly aligned and joints are of specified width.
- F. Install backsplashes and end splashes by adhering to wall and countertops with adhesive. Mask areas of countertops and splashes adjacent to joints to prevent adhesive smears.
- G. Install aprons to backing and countertops with adhesive. Mask areas of countertops and splashes adjacent to joints to prevent adhesive smears. Fasten by screwing through backing. Predrill holes for screws as recommended by manufacturer.
- H. Complete cutouts not finished in shop. Mask areas of countertops adjacent to cutouts



123661.16  
SOLID SURFACING COUNTERTOPS

to prevent damage while cutting. Make cutouts to accurately fit items to be installed, and at right angles to finished surfaces unless beveling is required for clearance. Ease edges slightly to prevent snipping.

1. Seal edges of cutouts in particleboard subtops by saturating with varnish.
- I. Apply sealant to gaps at walls; comply with Section 079200 "Joint Sealants."

END OF SECTION 123661.16